

2015

**MAINZ**

# Mainz

## Product Catalogue

Stainless steel wire, fittings, hardware and tools for wire balustrades

### Stainless steel wire



### Stainless steel hardware and fittings



### Tools



Mainz Pty Ltd  
Ph: (08) 92756246  
[www.WireBalustrades.com.au](http://www.WireBalustrades.com.au)  
14 January 2015

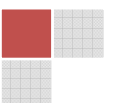

## Table of Contents

<b>Stainless Steel Wire</b> .....	<b>3</b>
<b>Stainless Steel Fittings</b> .....	<b>4</b>
Open Turnbuckles .....	4
Closed Turnbuckles .....	4
Swageless Fittings .....	6
Terminals.....	7
Eye Screws.....	8
Saddles .....	8
Eye Plates .....	8
Eye Bolts.....	9
Ferrules .....	10
Thimbles.....	10
Screws .....	11
Pop Rivets.....	11
Nuts .....	11
Rivet Nuts.....	11
Tensioners.....	12
D Shackles .....	12
Snap Hooks.....	12
Wire Rope Clips.....	13
Double Thread Stubs.....	13
<b>Tools</b> .....	<b>12</b>
Crimping tools .....	14
Wire Cutting tools .....	14
Rivet Nut Insert Tools.....	14

## Stainless Steel Wire

Stock Code	Construction	Grade	Size mm	Roll Length Metres	Price
707012-305M	7 x 7	316	1.2	305	\$126
707020-305M	7 x 7	316	2	305	\$190
707025-305M	7 x 7	316	2.5	305	\$220
707032-305M	7 x 7	316	3.2	305	\$247
119032-305M	1 x19	316	3.2	305	\$350
707040-305M	7 x 7	316	4	305	\$450
707050-305M	7 x 7	316	5	305	\$660

Other sizes and grades available on request.

Wire is available per metre

Stock Code	Construction	Grade	Size mm	Price Per metre
707032-1M	7 x 7	316	2	\$0.80
707032-1M	7 x 7	316	2.5	\$0.90
707032-1M	7 x 7	316	3.2	\$0.97
707032-1M	1 x19	316	3.2	\$1.30
707032-1M	7 x 7	316	4	\$1.70
707032-1M	7 x 7	316	5	\$2.80

## Stainless Steel Fittings

### Open Turnbuckles

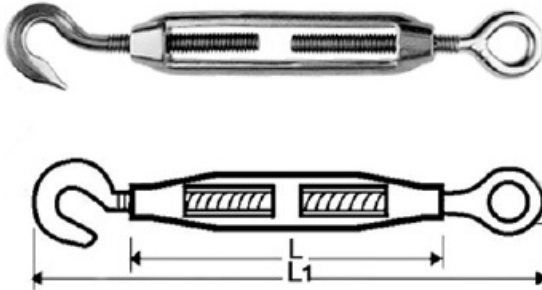

Stock Code	Style	Grade	Size mm	L mm	L1 mm	Price
1018-5	Hook and Eye	316	5	70	120	\$3.00
1018-6	Hook and Eye	316	6	90	150	\$4.75
1018-8	Hook and Eye	316	8	120	185	\$9.50
1018-10	Hook and Eye	316	10	150	235	\$12.50
2018-5	Eye and Eye	316	5	70	120	\$3.00
2018-6	Eye and Eye	316	6	90	150	\$4.75
2018-8	Eye and Eye	316	8	120	185	\$9.50
3018-8	Hook and Hook	316	8	120	185	\$9.50

Other sizes and grades available on request.

### Closed Turnbuckles – Jaw/Jaw

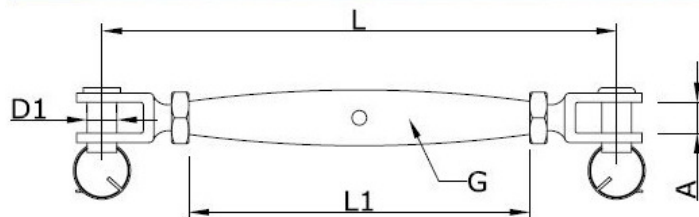
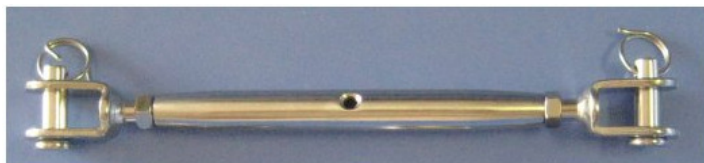

Stock Code	Style	Grade	Size mm	L mm	L1 mm	D1 mm	A mm	Price
023-5	Jaw - Jaw	316	5	130	80	5	8	\$4.95
023-6	Jaw - Jaw	316	6	145	92	6	9	\$6.50
023-8	Jaw - Jaw	316	8	1167	105	8	12	\$12.50

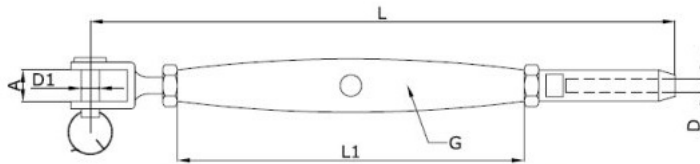
**Closed Turnbuckles – Jaw/swage**

Stock Code	Style	Grade	Size mm	Wire Size mm	L mm	L1 mm	D1 mm	A mm	Price
024-5	Jaw - Swage	316	5	3.2	158	80	5	8	\$4.95
024-6	Jaw - Swage	316	6	3.2	180	95	6	9	\$6.50
024-8	Jaw - Swage	316	8	5	205	105	8	11	\$12.50

**Closed Turnbuckles – Wood screw/swage**

Stock Code	Style	Grade	Size mm	Wire Size mm	L mm	L1 mm	Price
024-6-W	Wood screw - Swage	316	6	3.2	200	95	\$8.95

**Closed Turnbuckles – Wood screw/Jaw**

Stock Code	Style	Grade	Size mm	L mm	L1 mm	D1 mm	A mm	Price
023-6-JW	Wood screw - Jaw	316	6	180	95	6	9	\$8.95

## Swageless Fittings

### Swageless Turnbuckle



Stock Code	Style	Grade	Size mm	Wire Size mm	Price
3045-6a	Swageless Turnbuckle	316	6	3.2	\$10.90
3045-6-4	Swageless Turnbuckle	316	6	4	\$16.50
3045-8-5	Swageless Turnbuckle	316	8	5	\$26.50

### Swageless Fork Terminal



Stock Code	Style	Grade	Size mm	Wire Size mm	Price
0035-32	Swageless Fork Terminal	316	6	3.2	\$7.90
0035-4	Swageless Fork Terminal	316	6	4	\$9.90
0035-5	Swageless Fork Terminal	316	8	5	\$14.50

### Swageless Terminal Stud



Stock Code	Style	Grade	Size mm	Wire Size mm	Price
3035-6a	Swageless Stud Terminal	316	6	3.2	\$7.90
3035-6-4	Swageless Stud Terminal	316	6	4	\$9.90
3035-8-5	Swageless Stud Terminal	316	8	5	\$14.50

## Terminals

### Woodscrew Swage Terminal



Stock Code	Style	Grade	Size mm	Wire Size mm	Price
04039-32-6L	Woodscrew swage terminal - Left thread	316	6	3.2	\$2.90
04039-32-6R	Woodscrew swage terminal - Right thread	316	6	3.2	\$2.90

### Swage Stud Terminal



Stock Code	Style	Grade	Size mm	Wire Size mm	Price
00039-32-6L	Stud swage terminal - Left thread	316	6	3.2	\$2.70
00039-32-6R	Stud swage terminal - Right thread	316	6	3.2	\$2.70

### Fork Swage Terminal

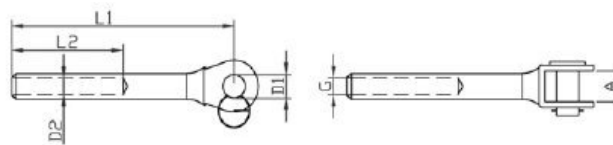
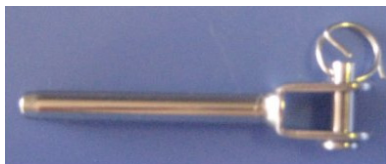

Stock Code	Style	Grade	Wire Size mm	L1 mm	L2 mm	D1 mm	A mm	Price
031-32	Jaw - Swage	316	3.2	66	38	5	8	\$2.70
031-5	Jaw - Swage	316	5	79	38	8	11	\$5.70

## Eye Screws



Stock Code	Style	Grade	Size mm	Thread mm	Length mm	Price
05037-6-40	Eye Screw	316	6	30	40	\$1.50
05037-6-60	Eye Screw	316	6	40	60	\$2.00
05037-8-60	Eye Screw	316	8	40	60	\$2.50
ESDB1	Eye Screw Drive Bit	316	Standard hex drive bit to suit our 40mm eye screws			\$12.00

## Saddles

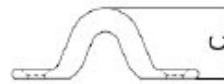
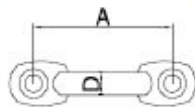

Stock Code	Grade	Size mm	A mm	C mm	D mm	Price
094-5	316	5	39	17	5	\$0.55

## Eye Plate



Stock Code	Grade	Size mm	W mm	L mm	H mm	T mm	Price
092-8	316	8	40	50	33	8	\$3.90



## Eye Bolts



Stock Code	Style	Grade	Size mm	Thread mm	Length mm	Price
0090-6-20	Eye Bolt	316	6	20	47	\$1.50

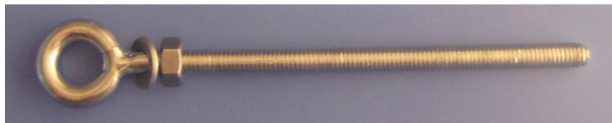

Stock Code	Style	Grade	Size mm	Thread mm	Length mm	Price
0091-6-40R	Eye Bolt with nut and washer – Right Thread	316	6	40	47	\$1.60
0091-6-40L	Eye Bolt with nut and washer – Left Thread	316	6	40	47	\$1.60
0091-6-60	Eye Bolt with nut and washer	316	6	60	67	\$2.00
0091-6-100	Eye Bolt with nut and washer	316	6	100	105	\$3.00

Other sizes and grades available on request.



DIN580 Eye Bolt with Collar

Stock Code	Style	Grade	Size mm	Thread mm	Length mm	Price
DIN580-6	Eye Bolt with collar	316	6	12	40	\$1.75
DIN580-8	Eye Bolt with collar	316	8	15	50	\$2.50
DIN580-10	Eye Bolt with collar	316	10	18	60	\$4.00

Other sizes and grades available on request.

## Ferrules

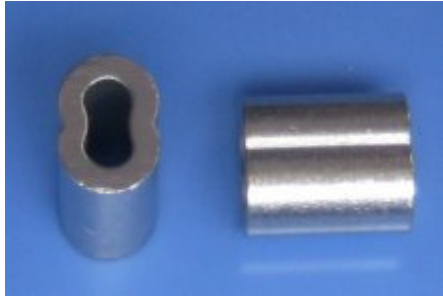

Stock Code	Style	Wire Size mm	Price
7040-2	Duplex ferrule - Nickel plated copper	2	\$0.65
7040-25	Duplex ferrule - Nickel plated copper	2.5	\$0.70
7040-32	Duplex ferrule - Nickel plated copper	3.2	\$0.75
7040-4	Duplex ferrule - Nickel plated copper	4	\$0.90
7040-5	Duplex ferrule - Nickel plated copper	5	\$1.80

Other sizes and grades available on request.

## Thimbles



Stock Code	Style	Wire Size mm	Grade	Price
052-2	Thimble	2	316	\$0.22
052-25	Thimble	2.5	316	\$0.25
052-32	Thimble	3.2	316	\$0.27
052-4	Thimble	4	316	\$0.40
052-5	Thimble	5	316	\$0.50

Other sizes and grades available on request.

## Screws



Stock Code	Grade	Style	Length mm	Size mm	Price
6GX114	304	Countersunk, Phillips head, self tapper	1 1/2in (32mm)	6G	\$0.10
6GX1	316	Countersunk, Phillips head, self tapper	25mm	6G	\$0.15

## Pop Rivets

Stock Code	Grade	Style	Size mm	Price
POP4-8	304	Pop Rivet	4 * 8	\$0.20

## Blind Rivet Nut



Stock Code	Grade	Thread	Size mm	Price
BRNUT-5R	304	Right	5	\$0.80
BRNUT-6R	304	Right	6	\$0.90
BRNUT-6L	304	Left	6	\$1.50
BRNUT-8R	304	Right	8	\$1.00
BRNUT-10R	304	Right	10	\$1.20

## Nuts



Stock Code	Grade	Style	Size mm	Price
DNUT-6	316	Dome Nut	6	\$0.50
HNUT-6	316	Hex Nut	6	\$0.10

## Tensioners

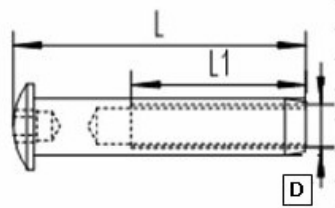

Stock Code	Grade	Style	D mm	L mm	L1 mm	Price
02050-6-48	316	Hex Dome head	6	48	30	\$3.70
12040-6-50	316	Cone head	6	50	35	\$3.20

## D Shackles



Stock Code	Grade	Size mm	Price
0001-6	316	6	\$1.60
0001-8	316	8	\$2.70

## Snap Hooks



Stock Code	Grade	Size mm	Price
026-8	316	8	\$2.90

## Wire Rope Clips



Stock Code	Grade	Size mm	Price
059-5	316	5	\$1.70

## Double Thread Stubs



Stock Code	Grade	Size mm	Thread	Price
1039-6	316	M6 x 70mm	Right	\$3.60

## T Nuts



Stock Code	Grade	Size mm	Price
TNUT-5	316	5	\$1.10

## Polish



Stock Code	Size	Description	Price
PP1	100ml	Peek Polish: Clean, polish and protect your stainless steel	\$16.50

## Tools

### Crimping tools



Stock Code	Description	Size mm	Price
HS14	Hand swaging tool Crimps size 1mm to 3.2mm Cuts wire up to 3.2mm	440	\$70.00
HS24	Heavy duty hand swaging tool Crimps five crimp sizes from 1mm to 5mm Cuts wire up to 5mm	600	\$87.00

### Cable Cutter



Stock Code	Description	Size mm	Price
A8	Hand wire cutting tool. Cuts wire up to 4mm	200	\$20.00
A18	Hand wire cutting tool. Cuts wire up to 10mm	450	\$85.00

### Blind Rivet Nut Insert Tool



Stock Code	Description	Size mm	Price
BT-605	Inserts rivet nuts M3, M4, M5, M6, M8 & M10	330	\$140.00
BTMAN-6L	BT-605 mandrill for inserting M6 left thread rivet nuts	M6	\$20.00